



# Operation and Safety Guide

## Ground Hog Trencher

### Model # T-4-HS18

Vendor Website: [www.groundhoginc.com](http://www.groundhoginc.com)

Support Phone No. 800-922-4680

**⚠ DANGER**



Read the entire Operator's Manual before using this trencher! Restrict the use of this trencher to persons who read, understand, and follow the warnings and instructions in this manual and on the trencher. If you have not read and understand the warnings and instructions in this manual and on the trencher, you are not qualified to operate this trencher!

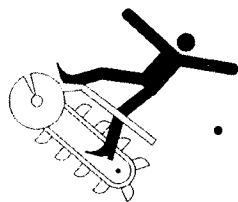

- Keep body parts, foreign objects and clothing clear of rotating auger and digging chain.
- Coming into contact with buried utilities while digging can cause severe injuries or DEATH.
- Contact appropriate utility representatives to determine if/where electrical cables, gas lines, water lines, etc. are buried BEFORE operation.
- Keep bystanders clear. If the throttle is set higher than idle when the engine is running, the digging chain and other components will move.
- **Do not** operate this trencher indoors. For outdoor use only.
- Hitting a buried object, such as a rock, could cause a sudden thrust to the operator. Injury could occur if the operator is not prepared to deal with this condition.



**Tool Application:** Anything requiring up to an 18" x 3" trench in soil.

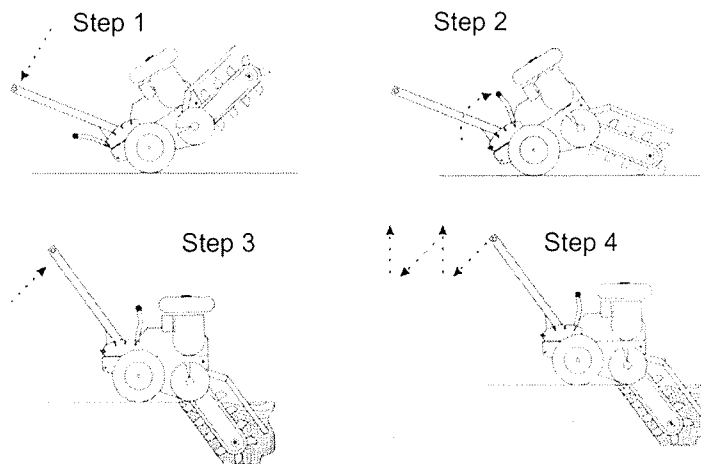

**Tool Operation:**

Step	Action
1	With the engine running and at an idle, apply downward pressure on the handlebar raising the digging chain.
2	Lift the depth control handle and slowly move the lever forward into the desired depth notch.
3	Apply downward pressure to the handlebar so the digging chain is not in contact with the ground. Increase the engine speed and hold on to the handlebar with both hands. Slowly relieve the downward pressure on the handlebar allowing the digging chain to penetrate the soil until the chosen depth is reached.
4	Using an intermittent pulling action, pull the trencher toward you 4 to 6 inches then relax your pull, allowing the trencher to again reach the chosen depth.
5	Repeat this action until you have finished the job. The wheel lock will aid you in this operation by helping to hold the trencher in position until the next motion is started.
6	This is a general description on how to trench. Soil conditions and operator experience will dictate actual trenching action and speed.